

Drawer Systems Fitting Instructions

**for Leisure Height (250 mm High) Steel & Aluminum
for Trade Height (400 mm High) Steel & Aluminum**

(GB) Fitting Instructions
(D) Montageanleitung
(NL) Montagevoorschrift
(F) Instructions de montage

(E) Instrucciones de montaje
(I) Schema di montaggio
(S) Manual
(RUS) руководство по монтажу



Steel Leisure Height Drawer Systems (250 mm High)



Steel Trade Height Drawer Systems (400 mm High)



45 min

Drawer Systems Fitting Instructions

for Leisure Height (250 mm High) Steel & Aluminum
for Trade Height (400 mm High) Steel & Aluminum

Required tools

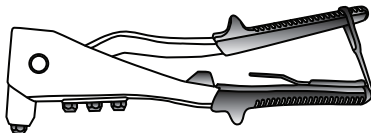

Fitting Kit

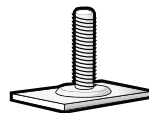

M10 x 40 x 1.25



M10



M10 x 1.25

x 4



Rivets

x 40

Side Wings / Side Bin Holders

Leisure Height Drawer Systems (250 mm High)

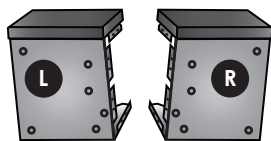

FR.1

(Front) x 2

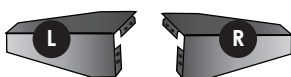

MID.1

(Middle) x 2

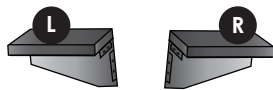

R.1

(Rear) x 2

Side Wings / Side Bin Holders

Trade Height Drawer Systems (400 mm High)

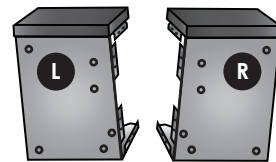

FR.1

(Front) x 2

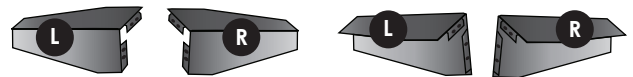

MID.1

(Middle) x 4

MID.2

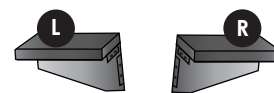

R.1

(Rear) x 2



45 min

Drawer Systems Fitting Instructions

for Leisure Height (250 mm High) Steel & Aluminum
for Trade Height (400 mm High) Steel & Aluminum

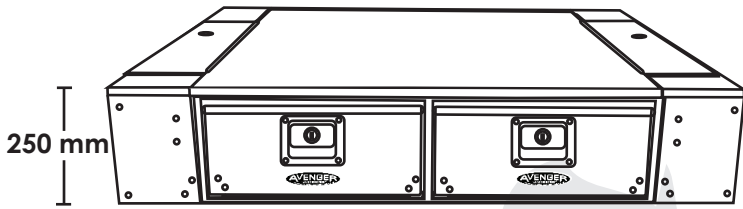

Steel Leisure Height Drawer Systems (250 mm High)
(P/N: ST250 - 1500)

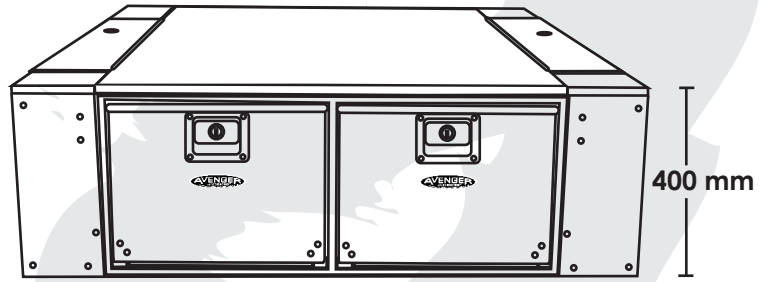

Steel Trade Height Drawer Systems (400 mm High)
(P/N: ST400 - 1500)

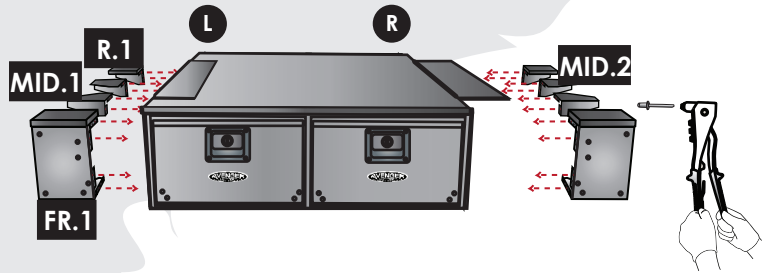
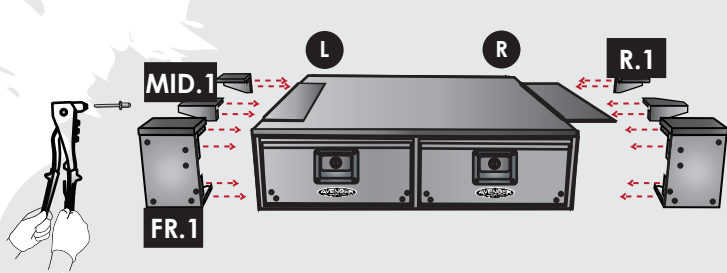

45 min

Drawer Systems Fitting Instructions

for Leisure Height (250 mm High) Steel & Aluminum
for Trade Height (400 mm High) Steel & Aluminum

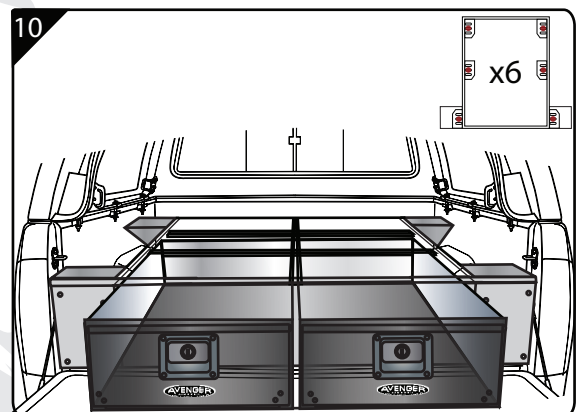
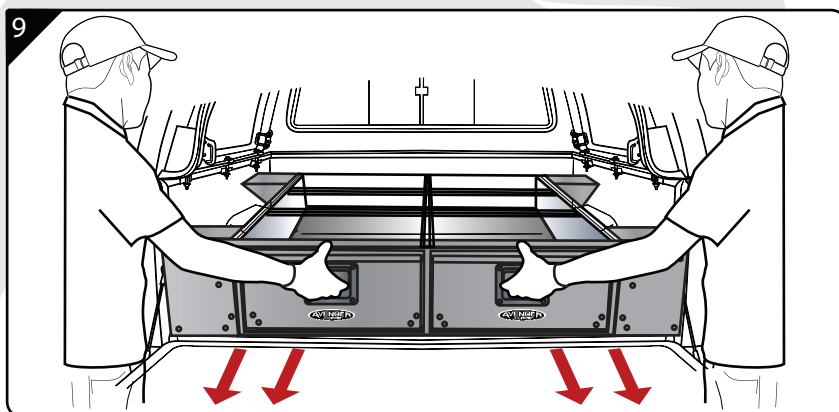
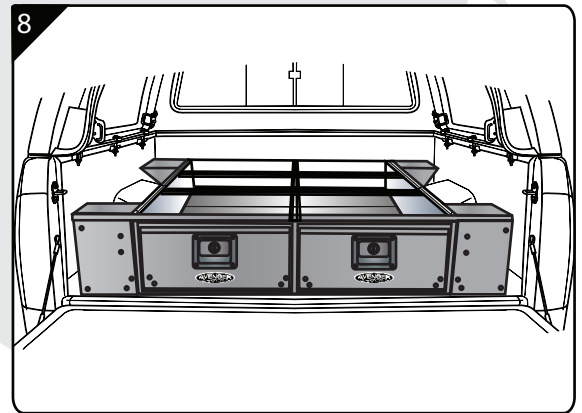
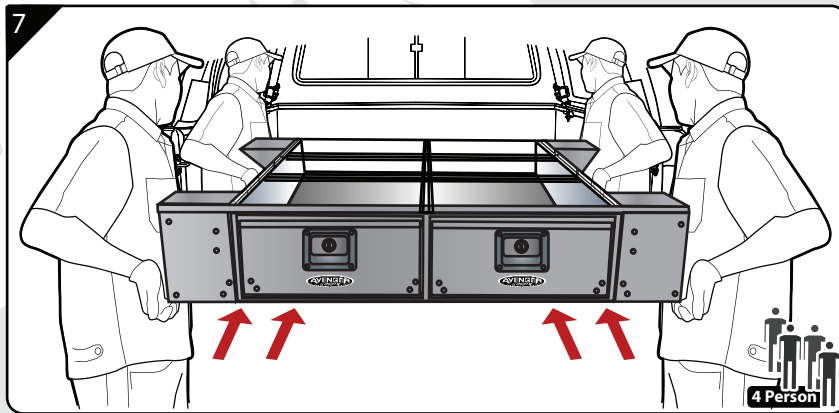
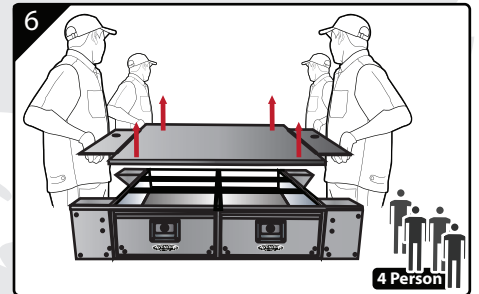
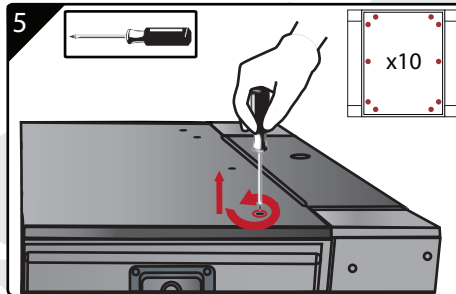
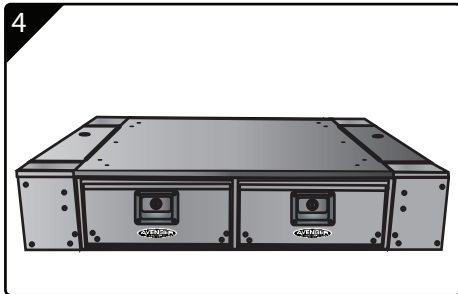
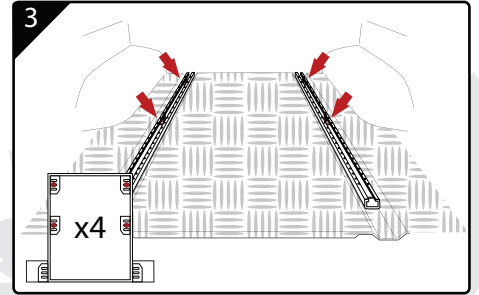
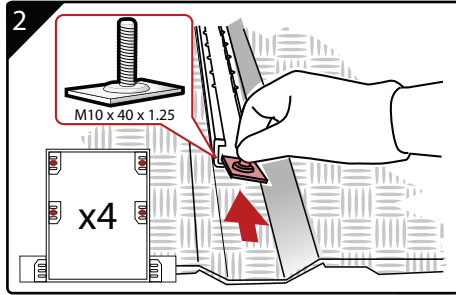
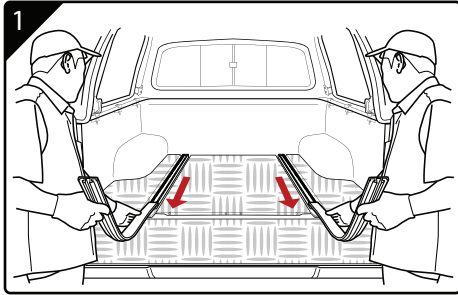

45 min

Drawer Systems Fitting Instructions

for Leisure Height (250 mm High) Steel & Aluminum
for Trade Height (400 mm High) Steel & Aluminum

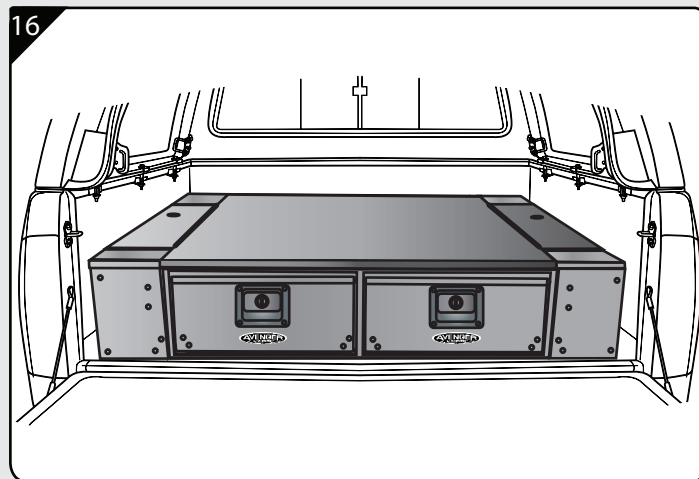
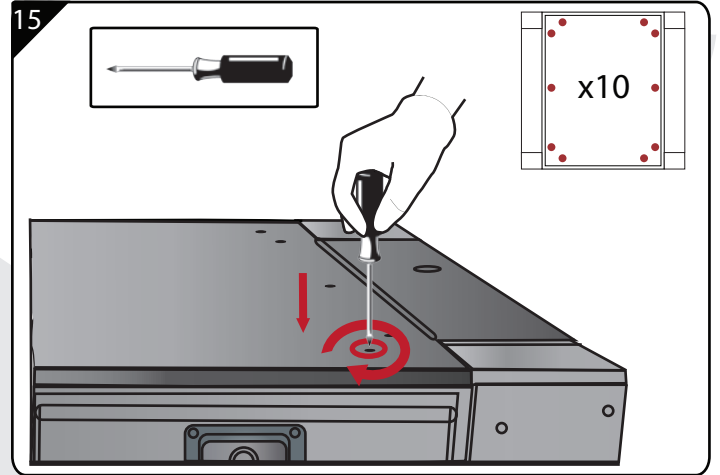
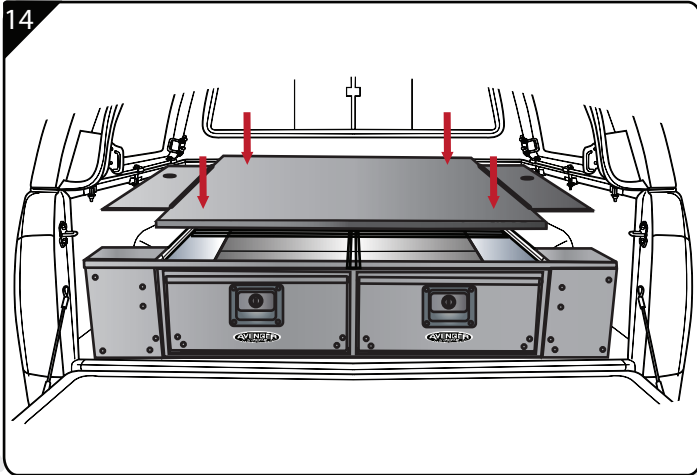
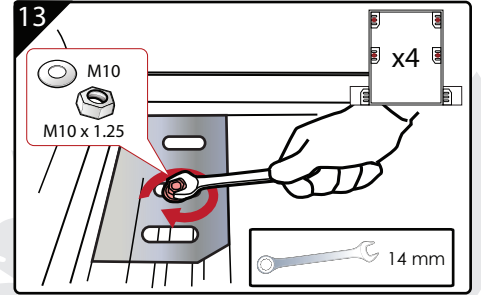
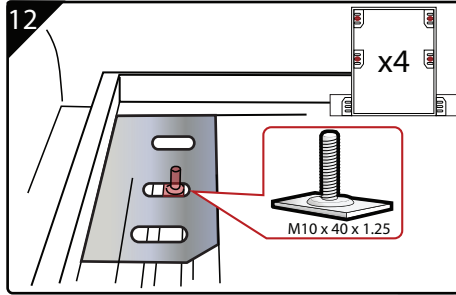
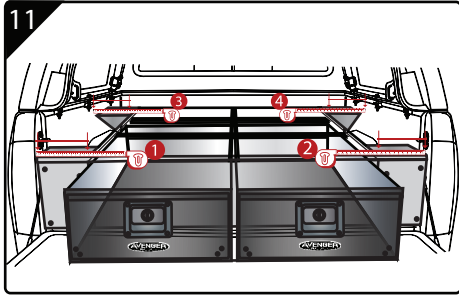

45 min